



SEEDING PROSPERITY AND REVITALIZING COORIDORS
Larimer & East Liberty, Pittsburgh

Chris Koch, GTECH Strategies
Fred Brown, Kingsley Association

National Vacant Properties Conference
June 21, 2012

Pittsburgh Vacant Land



Larimer Vacancy

- Total population: 13,000 in 1950 to 1728 in 2010
- 76% of HH are headed by single women with children
- 33% of parcels are vacant land
- 34% homeowners are elderly on fixed income
- 25% of existing housing is vacant
- Two poorest census tracts in the city
- Median Income: \$15-17K per year
- Flattest neighborhood in the city

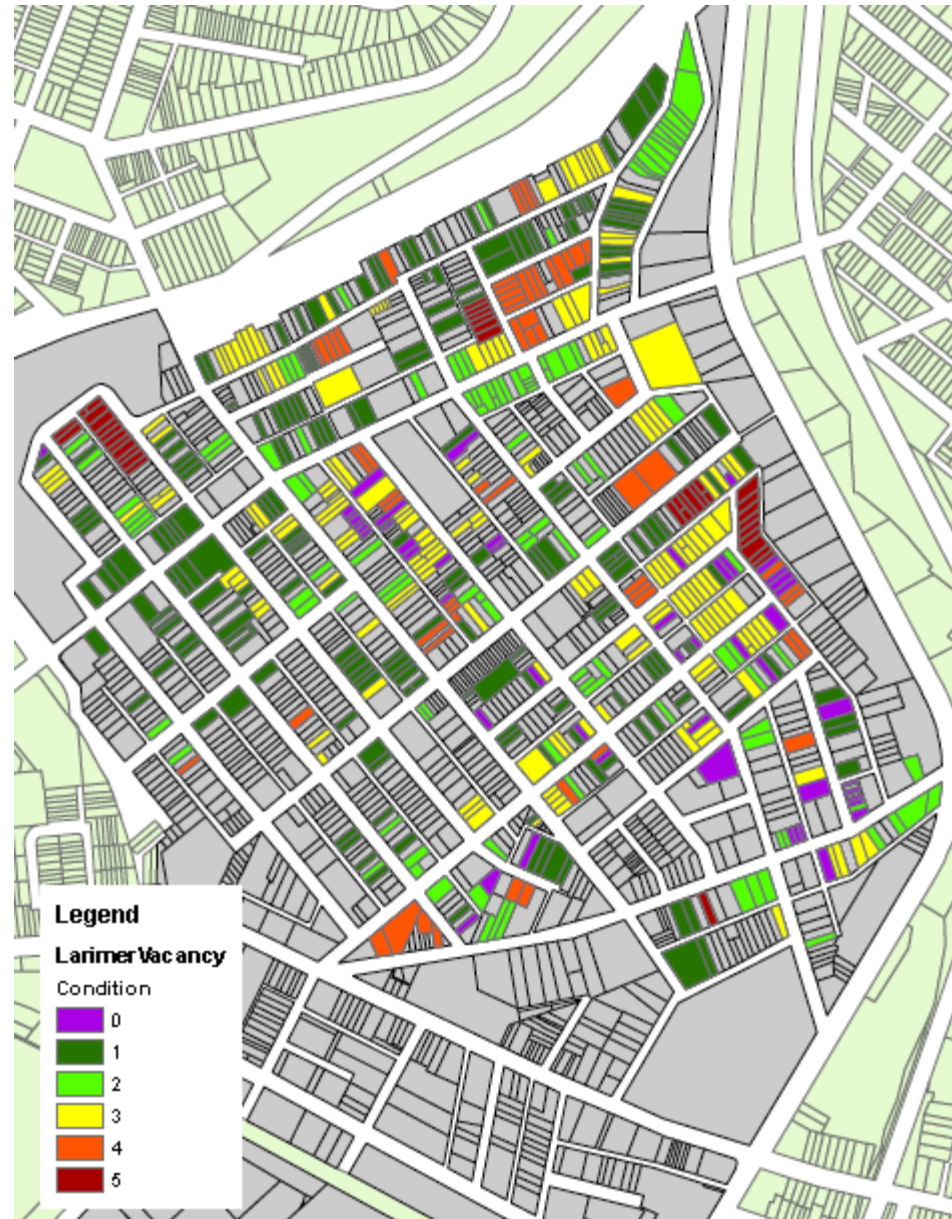

Larimer Community Vision Plan

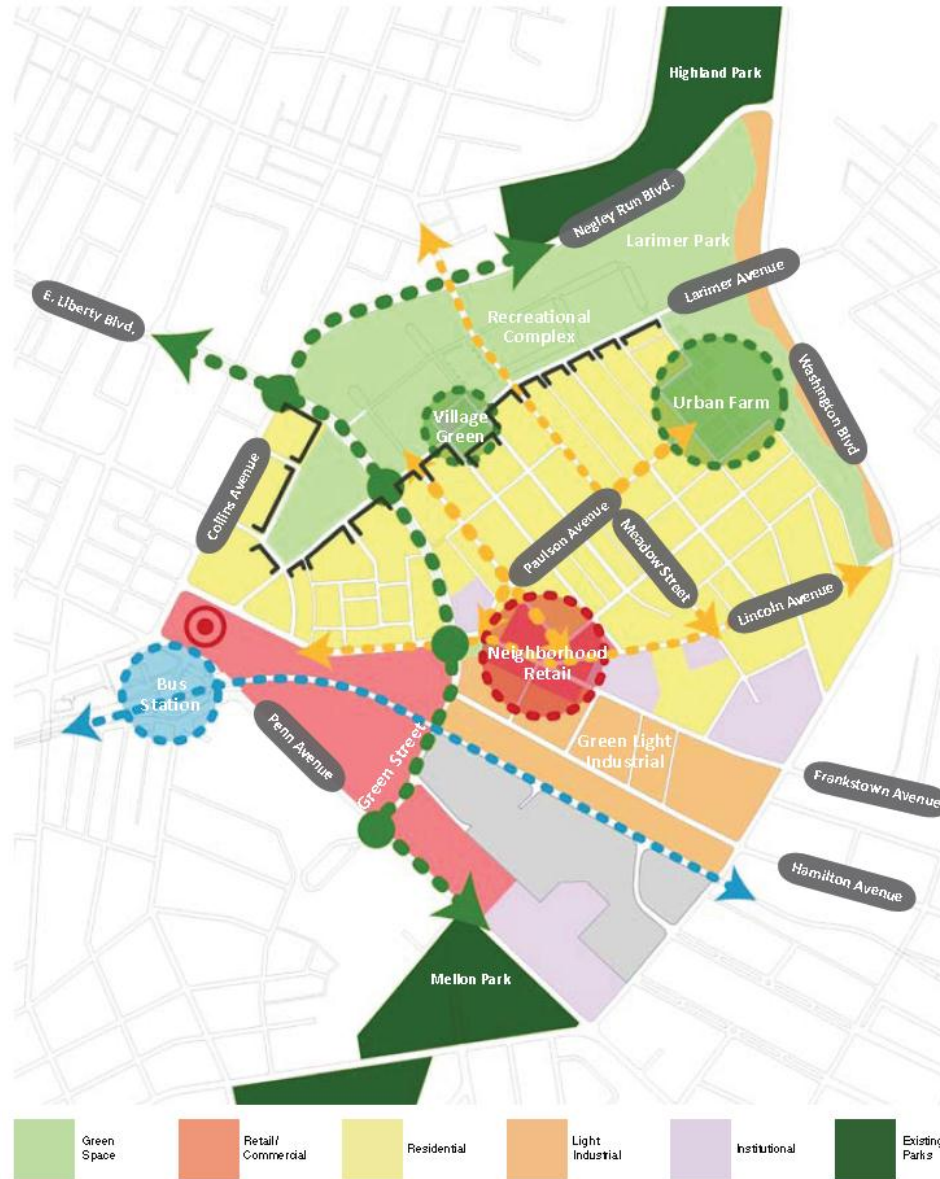

SPARC Goals

- Implement green strategies on 40 vacant lots
- Train and employ community members to provide maintenance through entrepreneurial landscape co-op
- Provide summer program for 12 youth
- Increase community capacity for future greening activities and development
- Rebuild relationships community and environmental sector
- Evaluate the impact of greening
- Expanding sustainable jobs and career pathways

SPARC CORRIDOR



The image shows a community garden with a wooden fence in the foreground. Yellow flowers are in bloom. In the background, there are raised garden beds with various plants, trees, and a brick house. A sign is attached to the fence, providing information about the Larimer Community Garden & Urban Farm.

The Larimer Community Garden & Urban Farm

Sponsored by the ...
Larimer Green Team

In collaboration with ...
Urban Redevelopment Authority
City of Pittsburgh Mayor's Office
Grow Pittsburgh
GTECH Strategies
Penn State Extension

Please join us in rebuilding Larimer!

For more information about getting involved - e-mail us at:
LarimerGreenTeam@gmail.com or call: 412-661-8751 ext. 175















The Kingsley Association



*To inspire and promote our community growth
as a physical anchor; social, wellness, and
service program provider and thought leader*

The Kingsley Association Core Areas

Created in 1893

Aids residents from 0-80

160,400 visitors annually

Serves 26 zip codes

Median incomes 15K-200K

- Community Sustainability and Development:
- Health & Wellness:
- Education & Training:
- Family Services:
- Kingsley Center:



Vacant Land

Public



Private



Kingsley Association





Economic Gardening Principles: Building Community Capacity

Information: Providing valuable and concise information that informs the community of our:

Infrastructure: Identifying resources to support sustainable change in the community that ties to our mission.

Connections: Building relationships and creating experiences that empower people to change their own lives.



Community Conversation about a vision for a right sized community from 13000-1728-?

Develop a strategic road
map that incorporates the
Land Use & Market Study
Plan that focuses on how
the Kingsley Association can
support:

Place & Environment

Long-range vision

Community & Organization

Road Map for future
development

Human Needs

Necessary tools



